

# Elec. Finger Touch/Key Pad Cam Lock "Phil"

## Product introduction:

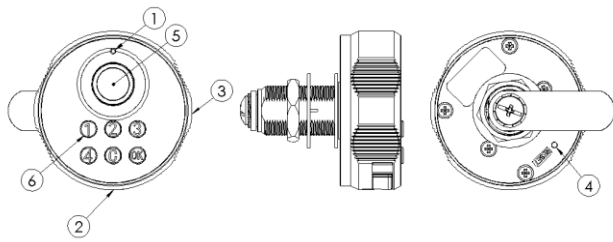

1. LED indicator
2. Battery compartment, use Cr2450 button cell battery
3. Type-C port, used for emergency charging
4. Reset button, used for factory setting recovery
5. Fingerprint module
6. Keyboard

## Usage mode/Reset:

1. Initialization by using a tool: Insert a pin into the reset button via the reset hole on the back of the device, press and hold it for at least 3 seconds until a single 'beep' is heard, indicating that initialization has been successful. The device will be reset in private mode, the administrator password will be reset to 112233, all user passwords will be reset to 123, and all fingerprints will be deleted.
2. The product offers one operating mode: private.

## Instructions:

1. Changing the administrator password: The default administrator password is 112233. There is no limit on the administrator password digits. Enter the following via the keypad:

Original admin password + C + C + New admin password + OK. A single short beep indicates the change has been successful.

Example: To change the admin password from 112233 to 1234, enter 0, 1, 1, 2, 2, 3, 3, C, C,

0, 1, 2, 3, 4, OK. The password has been successfully changed.

2. Private Mode: The initial password is 123; there is no limit on password digits.

- 1) Unlock: Enter the password + OK, a long beep indicates success. Turn the knob to the unlocked position within 3 seconds to complete the unlocking process.
- 2) Lock: Simply turn the knob to the locked position at any time.
- 3) Change Password: Enter the current password + C + new password + OK. A single long "beep" indicates the password has been successfully changed.

Example: To change the default password from 123 to 234, enter 0, 1, 2, 3, C, 2, 3, 4, OK.

The password has been successfully changed;

# Fingerprint operation

## 1. Instructions for first-time use.

- 1) No fingerprints have been enrolled on the new lock at the time of manufacture. Users can unlock the door by pressing any fingerprint; please enroll your fingerprints in time.
- 2) This fingerprint lock can store up to 30 fingerprints, with the first two registered fingerprints designated as administrators by default.

## 2. Enroll the 1st Administrator fingerprint (the 1st fingerprint enrolled is automatically designated as 1st Administrator)

- 1) Press and hold the fingerprint for approximately 4 seconds or longer until the green light flashes and you hear two intermittent beeps, then release the fingerprint;
- 2) Enroll the administrator's fingerprint four times within 5 seconds; a single long "beep" will sound to indicate successful enrolment if all attempts are successful.
- 3) Note: a single "beep" indicates success for each enrolment attempt, whilst two "beeps" indicate failure; Continuous and successful enrolments reach up to 4 times will be seen as qualified.

## 3. Enroll 2<sup>nd</sup> Administrator fingerprint (the second fingerprint enrolled is automatically designated as 2<sup>nd</sup> Administrator)

- 1) Press and hold the 1<sup>st</sup> Administrator's fingerprint for approximately 4 seconds or longer until the green light flashes and you hear two intermittent beeps, then release the fingerprint;
- 2) Enroll the user's fingerprint four times within 5 seconds; a single long "beep" will sound to indicate successful enrolment if all attempts are successful.
- 3) Note: a single "beep" indicates success for each enrolment attempt, whilst two "beeps" indicate failure; Continuous and successful enrolments reach up to 4 times will be seen as qualified.

## 4. Enroll general user fingerprints (the 3<sup>rd</sup> to 30<sup>th</sup> fingerprints enrolled are set as general users by default)

- 1) Press and hold the administrator's fingerprint for approximately 4 seconds or longer until the green light flashes and you hear two intermittent beeps, then release the fingerprint;
- 2) Enroll the user's fingerprint four times within 5 seconds; a single long "beep" will sound to indicate successful enrolment if all attempts are successful.
- 3) Note: A single "beep" indicates success for each enrolment attempt, whilst two "beeps" indicate failure; Continuous and successful enrolments reach up to 4 times will be seen as qualified.

## 5. Delete all fingerprints (including administrator fingerprints) and password initialization.

- 1) Press and hold the administrator's fingerprint for approximately 10 seconds or longer until the red and green lights flash alternately and you hear a series of short and intermittent 'beeps', then release the fingerprint;
- 2) Press any user's fingerprint once within 5 seconds to confirm, all fingerprints have been successfully deleted while both the administrator and user passwords have been reset to their default settings when you hear a single long 'beep'. The current operating mode remains unchanged.
- 3) Note: All fingerprints have now been cleared at this moment. Users can unlock the door by pressing any fingerprint, please ensure users register their fingerprints promptly.

## 6. Fingerprint Unlocking

- 1) In private mode, both administrator fingerprints and user fingerprints can be used for unlocking;

## Battery replacement:

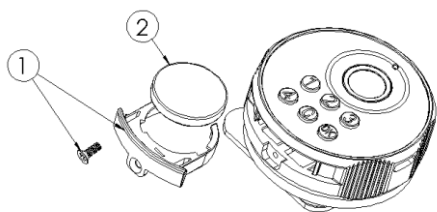

1. Use a screwdriver to remove the screws which are securing the battery compartment, then take out the battery compartment.
2. Replace with a new battery, battery model is Cr2450.
3. Insert the battery compartment into the lock and tighten the screws.

## Trouble shooting

Fault Symptoms	Main reason	Solutions
After entering the password/fingerprint, the lock is still at locked status after two beeps.	Wrong password/fingerprint	Input correct password/fingerprint
A continuous sound lasting one minute	Too many incorrect password/fingerprint attempts	Input correct password/fingerprint
After entering the password to unlock, the device emits three consecutive short beeps.	Low battery voltage	Replace new battery ASAP
Continuous beeping sound	Battery is running out	Replace the battery as soon as possible or use USB power source.

Installation Methods: A. wooden door installation method. B. steel door installation method.

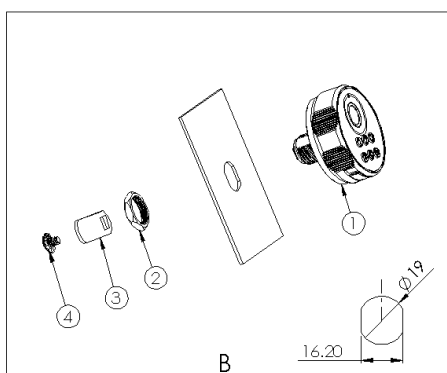
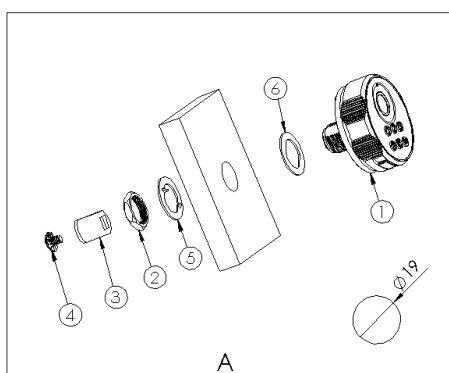

## Notes:

1. Battery specifications: Cr2450, battery life: 2000+ times;
2. Working temperature: -10°C~50°C;
3. Please remember administrator password and user password. Users can only use reset button to restore factory setting or use administrator fingerprint to initialize management password and user password when both passwords are forgotten.